



To buy

## 2 bed bungalow to buy in NE23

Gresham Close, Cramlington,  
Cramlington, Northumberland, NE23 6EJ

# £189,950

🏠 x2 🚗 x1 🚲 x1

Tenure

**Freehold**

Driveway & Garage parking

## Property features

- ✓ Two double bedrooms
- ✓ Great location
- ✓ Garage and driveway
- ✓ Generous living room
- ✓ EPC Rating D

## Key Information

- ✓ Council Tax: Band B
- ✓ EPC Rating: D
- ✓ Heating supply: Ducted Air

## Description

Fantastic opportunity to purchase a bungalow in this very popular estate. This super property has lots to offer and will make a great project for a buyer looking to live in Southfield Green.

This home is well located on a corner plot with a driveway for space for parking two vehicles, garage and gardens to the front and rear.

The property comprises entrance hallway, spacious living/dining room, kitchen, bathroom and two bedrooms. There are french doors opening to the garden as well.

To view this lovely home please call us today to arrange your viewing.

Council Tax Band: B

Tenure: Freehold

Price: £189,950

Property Type: Bungalow

Parking: Driveway & Garage

Heating: Ducted Air

## Entrance hallway



## Living Room



## Kitchen



## Bedroom 1



## Bedroom 2



## Bathroom



---

## External



Approx Gross Internal Area  
72 sq m / 774 sq ft

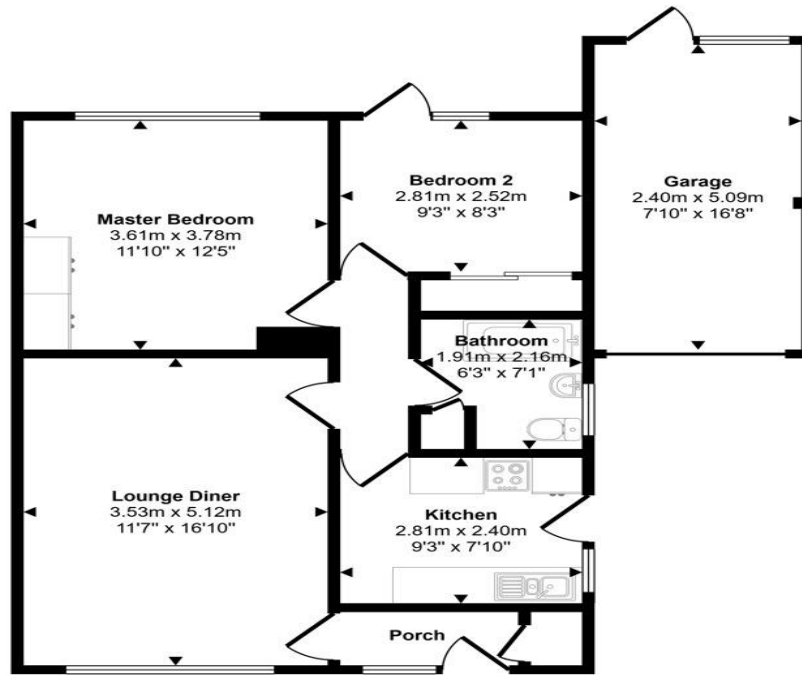

Floorplan

This floorplan is only for illustrative purposes and is not to scale. Measurements of rooms, doors, windows, and any items are approximate and no responsibility is taken for any error, omission or mis-statement. Icons of items such as bathroom suites are representations only and may not look like the real items. Made with Made Snappy 360.

Energy Efficiency Rating		
	Current	Potential
<i>Very energy efficient - lower running costs</i>		
(92-100) <b>A</b>		
(81-91) <b>B</b>		86
(69-80) <b>C</b>		
(55-68) <b>D</b>	63	
(39-54) <b>E</b>		
(21-38) <b>F</b>		
(1-20) <b>G</b>		
<i>Not energy efficient - higher running costs</i>		
<b>England, Scotland &amp; Wales</b>	EU Directive 2002/91/EC	

Gresham Close, Cramlington, Cramlington, Northumberland, NE23 6EJ

Contact your local branch today for more information on this property:

**107 London Road, Headington, Oxford, Oxfordshire, OX3 9HZ, [www.chancellors.co.uk](http://www.chancellors.co.uk)**

These particulars, whilst believed to be accurate are set out as a general outline only for guidance and do not constitute any part of an offer or contract. Intending purchasers should not rely on them as statements of representation of fact, but must satisfy themselves by inspection or otherwise as to their accuracy. No person in this firm's employment has the authority to make or give any representation or warranty in respect of the property.

