



4 bed semi-detached house to buy in NE15

Fergusons Lane, Denton Burn, Newcastle upon Tyne, Tyne and Wear, NE15 7PL

£230,000

🏠 x4 🚗 x2 🚻 x1

Tenure

Freehold

Driveway parking

Property features

- ✓ Semi Detached House
- ✓ Four Bedrooms
- ✓ Two Bathrooms
- ✓ Well Presented
- ✓ EPC Rating D

Key Information

- ✓ Council Tax: Band B
- ✓ EPC Rating: D
- ✓ Heating supply: Gas

Description

Situated on Fergusons Lane in Denton Burn, this spacious four bedroom semi-detached home offers a thoughtfully arranged layout suited to modern family living.

A porch provides a practical entrance into the property and opens into the main hallway, which leads through to a comfortable lounge. The open-plan kitchen and dining room creates a generous hub of the home, ideal for both everyday living and entertaining, and flows seamlessly into the conservatory, filling the space with natural light and views over the rear garden. The ground floor also benefits from a fourth bedroom with an adjoining shower room, offering excellent flexibility for guests, extended family, or home working, there is an additional store room. Upstairs, there are three well-proportioned bedrooms and a family bathroom with whirlpool Bath. The loft is accessed from the landing with a pul down ladder and floored storage.

Externally, the property features gardens to the front and a good-sized garden to the rear. Well located for access to local amenities, schools, and transport links, this home combines space, versatility, and convenience within Denton Burn, Newcastle upon Tyne.

Council Tax Band: B

Tenure: Freehold

Price: £230,000

Property Type: Semi-detached house

Parking: Driveway

Heating: Gas

Entrance Porch

Hallway

Lounge

4.30m x 3.70m (14'1" x 12'1")



Dining Room

3.70m x 4.30m (12'1" x 14'1")

Kitchen

5.40m x 1.90m (17'8" x 6'2")



Conservatory

3.70m x 2.10m (12'1" x 6'10")



Bedroom Four

3.40m x 3.40m (11'1" x 11'1")



Shower Room



Store Room

Stairs to First Floor

Bedroom One

3.80m x 2.60m (12'5" x 8'6")



Bedroom Two

2.50m x 3.30m (8'2" x 10'9")



Bedroom Three

2.50m x 2.70m (8'2" x 8'10")



Bathroom



Gardens



Approx Gross Internal Area
126 sq m / 1352 sq ft

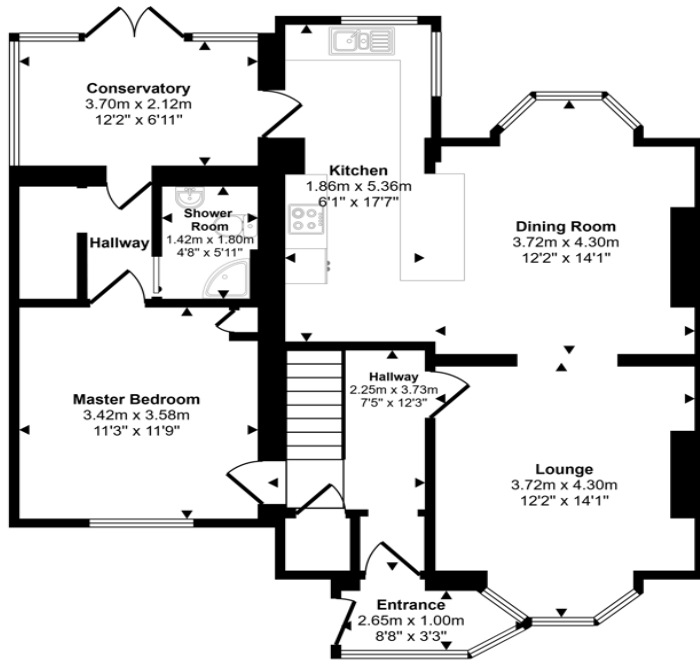

Ground Floor
Approx 84 sq m / 904 sq ft

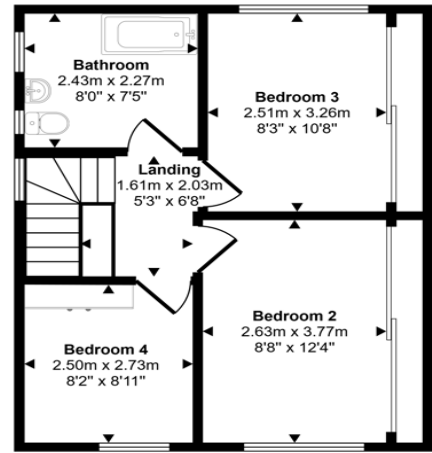

First Floor
Approx 42 sq m / 448 sq ft

This floorplan is only for illustrative purposes and is not to scale. Measurements of rooms, doors, windows, and any items are approximate and no responsibility is taken for any error, omission or mis-statement. Icons of items such as bathroom suites are representations only and may not look like the real items. Made with Made Snappy 360.

Energy Efficiency Rating		Current	Potential
<i>Very energy efficient - lower running costs</i>			
(92-100) A			
(81-91) B			82
(69-80) C			
(55-68) D		67	
(39-54) E			
(21-38) F			
(1-20) G			
<i>Not energy efficient - higher running costs</i>			
England, Scotland & Wales		EU Directive 2002/91/EC	

Fergusons Lane, Denton Burn, Newcastle upon Tyne, Tyne and Wear, NE15 7PL

Contact your local branch today for more information on this property:

107 London Road, Headington, Oxford, Oxfordshire, OX3 9HZ, www.chancellors.co.uk

These particulars, whilst believed to be accurate are set out as a general outline only for guidance and do not constitute any part of an offer or contract. Intending purchasers should not rely on them as statements of representation of fact, but must satisfy themselves by inspection or otherwise as to their accuracy. No person in this firms employment has the authority to make or give any representation or warranty in respect of the property.

