



### 3 bed semi-detached house to buy in NG17

Fishers Street, Kirkby-in-Ashfield,  
Nottingham, Nottinghamshire, NG17 9AH

**£135,000** Starting Bid

🏠 x3 🚗 x1 🚻 x1

Tenure

**Freehold**

Driveway parking

### Property features

- ✓ Being Sold via Secure Sale online bidding. Terms & Conditions apply
- ✓ Immediate 'exchange of contracts' available
- ✓ Semi detached property
- ✓ Two reception rooms
- ✓ EPC Rating C

## Key Information

- ✓ Council Tax: Band A
- ✓ EPC Rating: C
- ✓ Heating supply: Gas
- ✓ Electric supply: National Grid
- ✓ Water supply: Direct mains water
- ✓ Broadband: FTTC (fibre to the cabinet)
- ✓ Mobile signal: Good

## Description

Being Sold via Secure Sale online bidding. Terms & Conditions apply.

This property will be legally prepared enabling any interested buyer to secure the property immediately once their bid/offer has been accepted. Ultimately a transparent process which provides speed, security and certainty for all parties.

### Auctioneers Additional Comments

Pattinson Auction are working in Partnership with the marketing agent on this online auction sale and are referred to below as 'The Auctioneer'.

This auction lot is being sold either under conditional (Modern) or unconditional (Traditional) auction terms and overseen by the auctioneer in partnership with the marketing agent.

The property is available to be viewed strictly by appointment only via the Marketing Agent or The Auctioneer. Bids can be made via the Marketing Agents or via The Auctioneers website.

Please be aware that any enquiry, bid or viewing of the subject property will require your details being shared between both any marketing agent and The Auctioneer in order that all matters can be dealt with effectively.

The property is being sold via a transparent online auction.

In order to submit a bid upon any property being marketed by The Auctioneer, all bidders/buyers will be required to adhere to a verification of identity process in accordance with Anti Money Laundering procedures. Bids can be submitted at any time and from anywhere.

Our verification process is in place to ensure that AML procedure are carried out in accordance with the law.

The advertised price is commonly referred to as a Starting Bid or Guide Price and is accompanied by a Reserve Price. The Reserve Price is confidential to the seller and the auctioneer and will typically be within a range above or below 10% of the Guide Price / Starting Bid.

These prices are subject to change.

An auction can be closed at any time with the auctioneer permitting for the property (the lot) to be sold prior to the end of the auction.

A Legal Pack associated with this particular property is available to view upon request and contains details relevant to the legal documentation enabling all interested parties to make an informed decision prior to bidding. The Legal Pack will also outline the buyers obligations and sellers commitments. It is strongly advised that you seek the counsel of a solicitor prior to proceeding with any property and/or Land Title purchase.

#### Auctioneers Additional Comments

In order to secure the property and ensure commitment from the seller, upon exchange of contracts the successful bidder will be expected to pay a non-refundable deposit equivalent to 5% of the purchase price of the property. The deposit will be a contribution to the purchase price. A non-refundable reservation fee up to 6% inc VAT (subject to a minimum which could be up to £7,200 inc VAT) is also required to be paid upon agreement of sale. The Reservation Fee is in addition to the agreed purchase price and consideration should be made by the purchaser in relation to any Stamp Duty Land Tax liability associated with overall purchase costs.

Both the Marketing Agent and The Auctioneer may believe necessary or beneficial to the customer to pass their details to third party service suppliers, from which a referral fee may be obtained. There is no requirement or indeed obligation to use these recommended suppliers or services.

Council Tax Band: A

Tenure: Freehold

Price: Starting Bid £135,000

Property Type: Semi-detached house

Parking: Driveway

Construction materials: Brick and block

Roofing type: Slate tiles

Known property issues: Damp

Risk of floods and or erosion: No

Flooded in last 5 years: No

Flood defences: No

Planning permissions or proposals for development: No

Coalfield or mining area: No

Listed property: No

Conservation area: No

Public rights of way: No

Adaptions for accessibility: No

Restrictions: No

Required access: No

Heating: Gas

Electric: National Grid

Water: Direct mains water

Sewerage: Standard UK domestic

Air conditioning: No

Broadband: FTTC (fibre to the cabinet)

Mobile signal coverage: Good

## Lounge

2.20m x 4.80m (7'2" x 15'8")

---

## Dining Room

4.21m x 4.78m (13'9" x 15'8")

---

## Kitchen

4.30m x 2.36m (14'1" x 7'8")

---

## Bedroom One

4.34m x 2.44m (14'2" x 8'0")

---

## Bedroom Two

1.95m x 3.93m (6'4" x 12'10")

---

## Bedroom Three

2.20m x 4.01m (7'2" x 13'1")

---

## Bathroom

1.92m x 2.19m (6'3" x 7'2")

Approx Gross Internal Area  
87 sq m / 935 sq ft

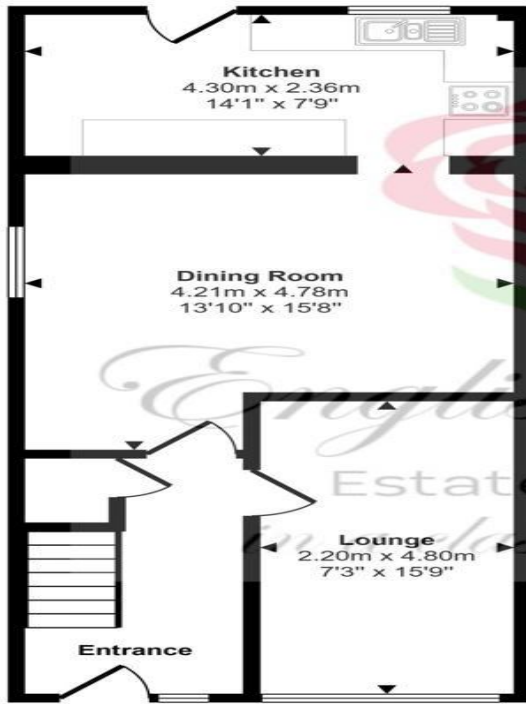

**Ground Floor**  
Approx 48 sq m / 520 sq ft

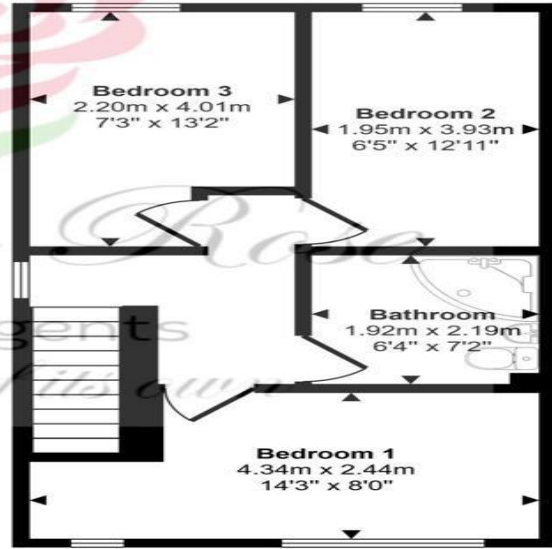

**First Floor**  
Approx 39 sq m / 415 sq ft

This floorplan is only for illustrative purposes and is not to scale. Measurements of rooms, doors, windows, and any items are approximate and no responsibility is taken for any error, omission or mis-statement. Icons of items such as bathroom suites are representations only and may not look like the real items. Made with Made Snappy 360.

| Energy Efficiency Rating                    |  | Current                    | Potential |
|---|--|----------------------------|-----------|
| Very energy efficient - lower running costs |  |                            |           |
| (92-100) <b>A</b>                           |  |                            |           |
| (81-91) <b>B</b>                            |  |                            | 86        |
| (69-80) <b>C</b>                            |  | 69                         |           |
| (55-68) <b>D</b>                            |  |                            |           |
| (39-54) <b>E</b>                            |  |                            |           |
| (21-38) <b>F</b>                            |  |                            |           |
| (1-20) <b>G</b>                             |  |                            |           |
| Not energy efficient - higher running costs |  |                            |           |
| <b>England, Scotland &amp; Wales</b>        |  | EU Directive<br>2002/91/EC |           |

Fishers Street, Kirkby-in-Ashfield, Nottingham, Nottinghamshire, NG17 9AH

Contact your local branch today for more information on this property:

**107 London Road, Headington, Oxford, Oxfordshire, OX3 9HZ, [www.chancellors.co.uk](http://www.chancellors.co.uk)**

These particulars, whilst believed to be accurate are set out as a general outline only for guidance and do not constitute any part of an offer or contract. Intending purchasers should not rely on them as statements of representation of fact, but must satisfy themselves by inspection or otherwise as to their accuracy. No person in this firm's employment has the authority to make or give any representation or warranty in respect of the property.

