



## 1 bed flat to buy in N12

Torrington Park, London, London, N12 9TT

**£275,000** Starting Bid

🛏 x1 🚿 x1 🚻 x1

Tenure

**Leasehold**

Allocated parking

## Property features

- ✓ Immediate 'exchange of contracts' available
- ✓ Being sold via 'Secure Sale'
- ✓ Excellent Location
- ✓ Spacious one bed flat
- ✓ EPC Rating D

## Key Information

- ✓ Council Tax: Band B
- ✓ EPC Rating: D
- ✓ Heating supply: Gas
- ✓ Electric supply: National Grid
- ✓ Water supply: Direct mains water
- ✓ Broadband: FTTC (fibre to the cabinet)
- ✓ Mobile signal: Good

## Description

• \*\* Being sold via Secure Sale online bidding. Terms & Conditions apply. Starting Bid £275,000 \*\*\*

Finchleys are delighted to present this well presented one double bedroom apartment situated within the popular Michelle Court, N12.

The property offers a bright, spacious lounge, a fully fitted and equipped kitchen, a modern bathroom with WC, and car parking on a first come, first serve basis.

The property is well located to local shopping amenities and is just under a mile from Woodside Park Underground Station on the Northern Line, providing convenient access to Central London.

The green spaces of Friary Park are a short walk from the property.

This flat would make an ideal purchase for first time buyers and investors alike. Don't miss out and contact us to

Lease: 172 years remaining

Service Charge: £1500 per annum

Ground Rent: £10 per annum

This property will be legally prepared enabling any interested buyer to secure the property immediately once their bid/offer has been accepted. Ultimately a transparent process which provides speed, security and certainty for all parties.

The property is being sold via a transparent online auction.

In order to submit a bid upon any property being

EPC Rating: D

Council Tax Band: B

Tenure: Leasehold

Length of Lease: 173

Price: Starting Bid £275,000

Property Type: Flat

Parking: Allocated

Year built: 1950

Construction materials: Brick and block

Risk of floods and or erosion: No

Flooded in last 5 years: No

Flood defences: No

Planning permissions or proposals for development: No

Coalfield or mining area: No

Listed property: No

Conservation area: No

Public rights of way: No

Adaptions for accessibility: No

Restrictions: No

Required access: No

Heating: Gas

Electric: National Grid

Water: Direct mains water

Water meter: No

Sewerage: Standard UK domestic

Air conditioning: No

Broadband: FTTC (fibre to the cabinet)

Mobile signal coverage: Good

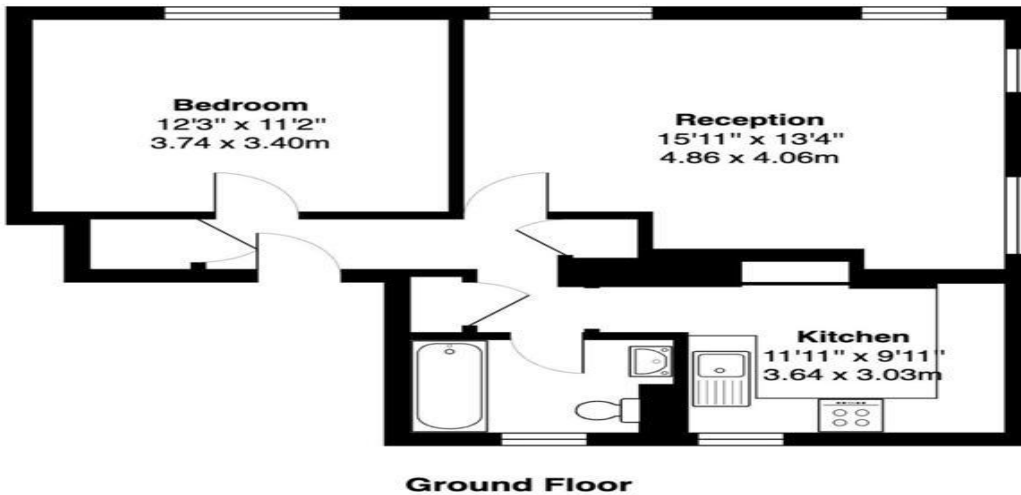

**Malvern Lodge, Torrington Park, N12**

**Total Gross Area: 577 ft<sup>2</sup> ... 53.6 m<sup>2</sup>**

All measurements are approximate and for identification guideline purposes only, not to scale.  
Compliant with the RICS code of measuring practice



Energy Efficiency Rating		Current	Potential
<i>Very energy efficient - lower running costs</i>			
(92-100) <b>A</b>			
(81-91) <b>B</b>			
(69-80) <b>C</b>			78
(55-68) <b>D</b>		65	
(39-54) <b>E</b>			
(21-38) <b>F</b>			
(1-20) <b>G</b>			
<i>Not energy efficient - higher running costs</i>			
<b>England, Scotland &amp; Wales</b>		EU Directive 2002/91/EC	

Torrington Park, London, London, N12 9TT

Contact your local branch today for more information on this property:

**107 London Road, Headington, Oxford, Oxfordshire, OX3 9HZ, [www.chancellors.co.uk](http://www.chancellors.co.uk)**

These particulars, whilst believed to be accurate are set out as a general outline only for guidance and do not constitute any part of an offer or contract. Intending purchasers should not rely on them as statements of representation of fact, but must satisfy themselves by inspection or otherwise as to their accuracy. No person in this firm's employment has the authority to make or give any representation or warranty in respect of the property.

